

## **STEEL | WOOD | FERMACELL 2E32, CONCRETE SLAB (APPROXIMATELY 3-4"), SUSPENDED CEILING WIRES AND CHANNELS | NAILED DOWN**

Acoustic performance

AiIC: 53 to 58

ASTC: 58 to 62

### **ASSEMBLY DETAILS**

#### **STRUCTURE**

Steel

#### **ASSEMBLY COMPONENTS**

Fermacell 2E32, Concrete slab (approximately 3-4"), Suspended ceiling wires and channels

#### **FLOOR TYPE**

Wood

#### **INSTALLATION TYPE**

Nailed down

#### **CEILING TYPE**

Suspended

#### **NUMBER OF GYPSUM**

1

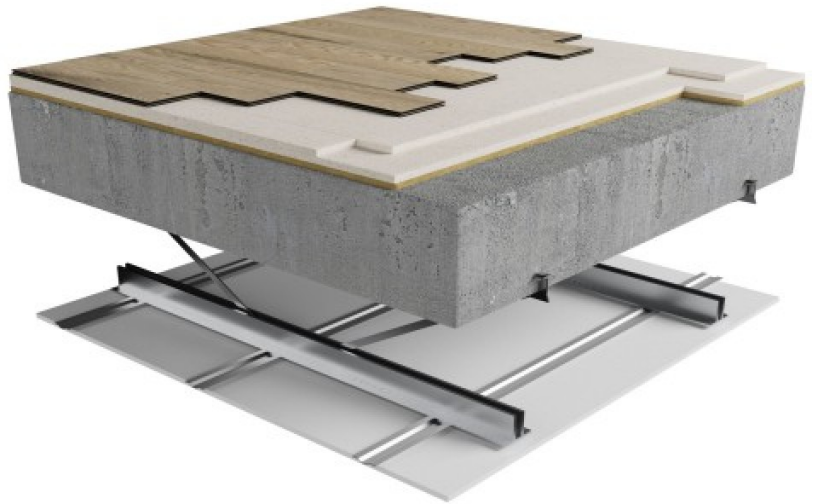

### **FERMACELL 2E32**

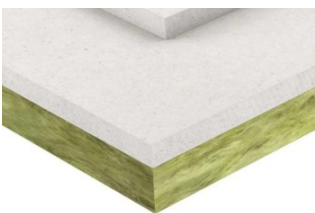

[Plus de détails](#)