

LIGHT WOOD | WOOD | FERMACELL 2E32, 5/8" T&G PLYWOOD, ACOUSTITECH VP | FLOATING

Acoustic performance
AIIIC: 55 to 59
ASTC: 56 to 59

ASSEMBLY DETAILS

STRUCTURE

Light wood

ASSEMBLY COMPONENTS

Fermacell 2E32, 5/8" T&G plywood,
AcoustiTECH VP

FLOOR TYPE

Wood

INSTALLATION TYPE

Floating

CEILING TYPE

Resilient channels

NUMBER OF GYPSUM

2



FERMACELL 2E32

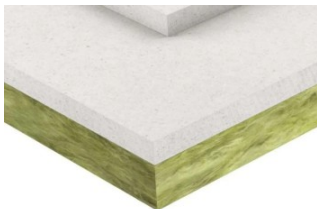

[Plus de détails](#)

ACOUSTITECH VP



[Plus de détails](#)