

## LIGHT WOOD | WOOD | FERMACELL 2E32, 5/8" T&G PLYWOOD, ACOUSTITECH VP, ACOUSTIVIBE | FLOATING

Acoustic performance  
AIIIC: 58 to 62  
ASTC: 59 to 61

### ASSEMBLY DETAILS

#### STRUCTURE

Light wood

#### ASSEMBLY COMPONENTS

Fermacell 2E32, 5/8" T&G plywood,  
AcoustiTECH VP, Acoustivibe

#### FLOOR TYPE

Wood

#### INSTALLATION TYPE

Floating

#### CEILING TYPE

Acoustic insulator

#### NUMBER OF GYPSUM

2



### FERMACELL 2E32

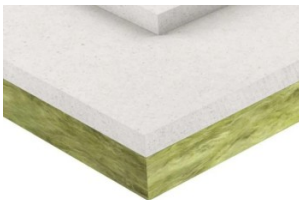

Plus de détails

### ACOUSTITECH VP



Plus de détails

### ACOUSTIVIBE



Plus de détails