

LIGHT WOOD | WOOD | FERMACELL 2E32, 5/8" T&G PLYWOOD | NAILED DOWN

Acoustic performance
AIIIC: 54 to 57
ASTC: 57 to 59

ASSEMBLY DETAILS

STRUCTURE

Light wood

ASSEMBLY COMPONENTS

Fermacell 2E32, 5/8" T&G plywood

FLOOR TYPE

Wood

INSTALLATION TYPE

Nailed down

CEILING TYPE

Resilient channels

NUMBER OF GYPSUM

2



FERMACELL 2E32

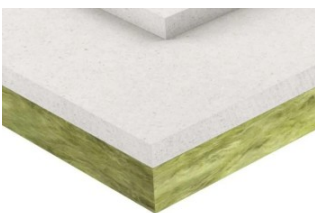

[Plus de détails](#)