

LIGHT WOOD | WOOD | FERMACELL 2E32, 5/8" T&G PLYWOOD | NAILED DOWN

Acoustic performance
AIIIC: 58 to 61
ASTC: 60 to 61

ASSEMBLY DETAILS

STRUCTURE

Light wood

ASSEMBLY COMPONENTS

Fermacell 2E32, 5/8" T&G plywood

FLOOR TYPE

Wood

INSTALLATION TYPE

Nailed down

GLUE

Mapei Eco Prim Grip

CEILING TYPE

Acoustic insulator

NUMBER OF GYPSUM

2



FERMACELL 2E32

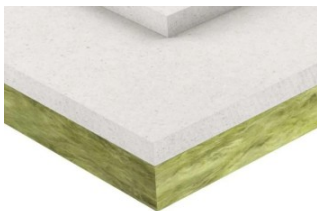

[Plus de détails](#)