

MASS TIMBER | WOOD | FERMACELL 2E32, INSONOFLOOR (SOPREMA) | FLOATING

Acoustic performance
AIIIC: 43 to 46
ASTC: 39 to 41

ASSEMBLY DETAILS

STRUCTURE

Mass timber

ASSEMBLY COMPONENTS

Fermacell 2E32, Insonofloor (Soprema)

FLOOR TYPE

Wood

INSTALLATION TYPE

Floating

CEILING TYPE

None

NUMBER OF GYPSUM

0



FERMACELL 2E32

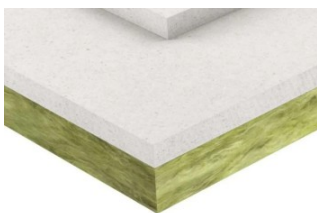

[Plus de détails](#)

INSONOFLOOR (SOPREMA)



[Plus de détails](#)